

RIVERVIEW SOLAR TECHNOLOGY PARK

Niagara River

Developer:

TM Montante Development

Architect:

Zaxis Architectural, P.C.

Location:

Tonawanda, New York, USA

Park Opened:

2007

Available Incentives:

USDA REAP/Low Cost Hydro Power

Masterplan

Zoning:

W-ID / WB

Pre-Approvals:

NYS Shovel Ready / BuildNowNY

Pre Approved Buildable:

924,631 square feet

Park Size:

Length: 4,618 feet

Width: 2,072 feet

Acreage: 183.78 acres

Solar Array 2010

400
Riverwalk Parkway
27,000 kWh generated
per year

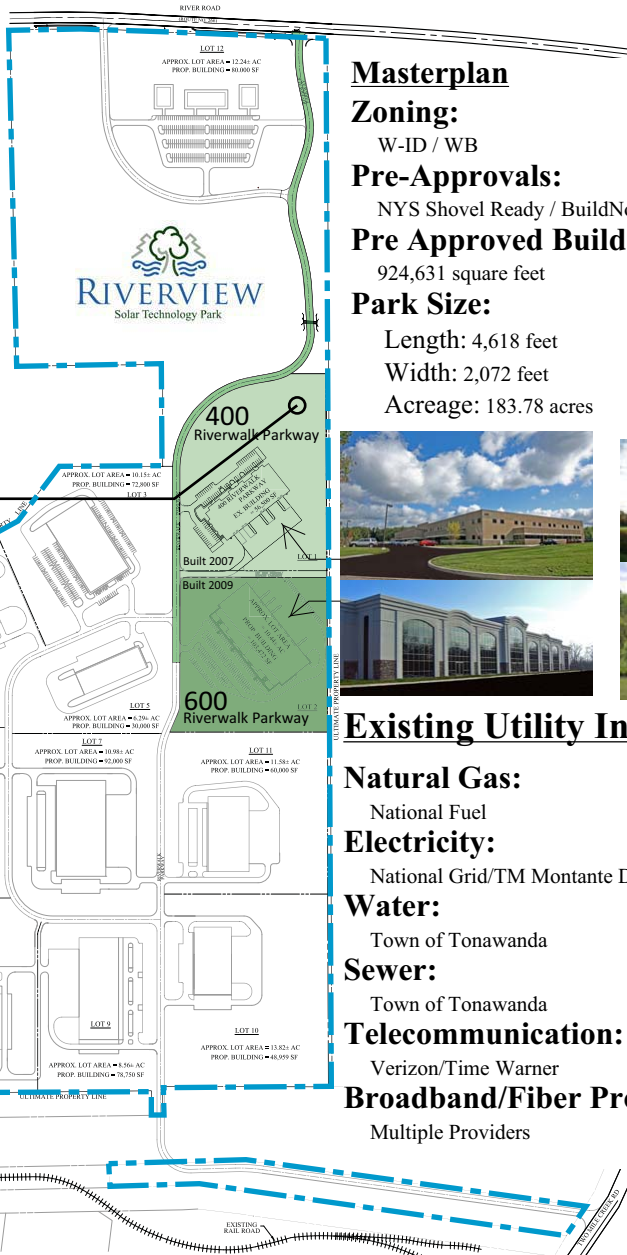

Park Access

Highway Access:

1 mile to Interstate-190 and I-290

Canada Border Access:

3 border crossings within 15 miles

10 minute drive to closest border

Airport Access:

2 International Airports

within 15 miles

Rail Access:

On-site



Existing Utility Infrastructure

Natural Gas:

National Fuel

Electricity:

National Grid/TM Montante Development (Solar)

Water:

Town of Tonawanda

Sewer:

Town of Tonawanda

Telecommunication:

Verizon/Time Warner

Broadband/Fiber Provider:

Multiple Providers

* Existing facilities and roads are highlighted in green.



About the Developer:

TM Montante Development is deeply rooted in New York State after eight decades of business experience. This closely held company, led by Thomas M. Montante, has a history of successful operations, beginning with a chain of auto service centers originating in the 1930's, to tire wholesale distribution and real estate development in the 1970's and eventually evolving into solar project development in 2008. TM Montante understands that electricity, both its source and cost, plays a vital role in attracting new business. Solar energy, along with other renewable energy sources, presents an opportunity to control future costs and provide a responsible solution to growing businesses. TMM provides its clients with land to develop, space to house a business, and solar energy solutions, including installation and project origination.